

WM800 RSM Overview

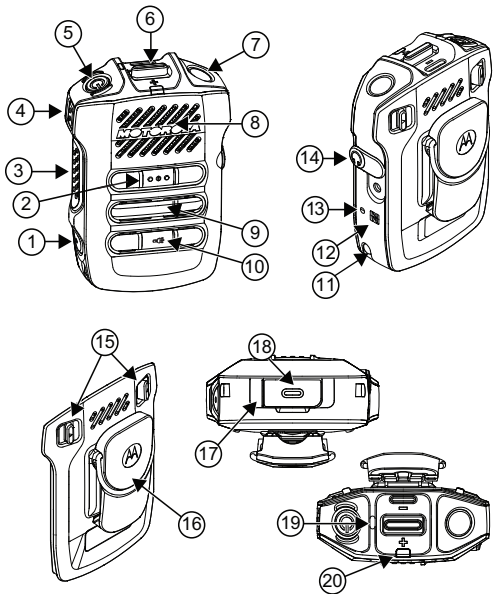

Table 1: WM800 RSM Overview and Description

No.	Description
1	1-Dot Button
2	3-Dot Button
3	Push-To-Talk (PTT) button
4	2-Dot Button
5	Power Button
6	Volume Toggle
7	Emergency Button
8	Microphone
9	Speaker
10	Task Light Button
11	Charging Contact
12	Near Field Communication (NFC) Tag
13	Blue Dot
14	Audio Jack
15	Battery Latch
16	Swivel Clip
17	Task Light
18	USB-C Jack
19	Power Indicator
20	Audio/Bluetooth Indicator

WM800 RSM Feature Overview

Table 2: WM800 RSM Feature Overview and Description

Feature	Functionality
Power On/Off	• Turn on or off the WM800 RSM by pressing and holding the Power button for two seconds.
Auto Power Off	• Cancel auto powering off by pressing the Power button once.
Check Battery and Connection Status	• When the RSM is turn on, press the Power button to check the battery and connection status. • Battery Statuses are as follows: - High: Blinking green twice. - Medium: Blinking amber twice. - Low: Blinking red twice. - Critical: Continuous blinking red. • Connection Statuses are as follows: “Searching for Host”, “Connecting”, “Connected”, “Reconnecting”, and “Disconnected”. • Audio/Bluetooth Indicator blinking blue twice when RSM is connected. • Voice or Tone Prompt are available.
Programmable Buttons	• You can program 1-Dot , 2-Dot , and 3-Dot buttons to different functions. Refer to the radio or host device user manual for detail.

Table 2: WM800 RSM Feature Overview and Description

Feature	Functionality
Voice Control	• Voice Assistant (ViQi) is available when the WM800 RSM is paired with a radio supporting ViQi. • Activate by pressing and holding the 3-dot programmable button.
Task Light Control	• Turn the Task Light on or off by pressing the Task Light button for one second.
Volume Controls	• Adjust the volume level by pressing the + or - button. • Ramp up or down the volume level by pressing and holding the + or - button.
Tone and Voice Prompt Selection	• Select tone or voice prompt when the RSM is in pairing mode by pressing the 2-dot button. NOTE: To set tone or voice prompt, ensure that the RSM is not connected to any host device.
Clear Device from Pairing List	• Remove host device from the WM800 RSM pairing list by pressing and holding the PTT and Power buttons simultaneously.
Error Indication	• Occurs in the event of any product error. The WM800 RSM Power and Audio/Bluetooth Indicator is blinking red.

Dual-unit Charger Overview

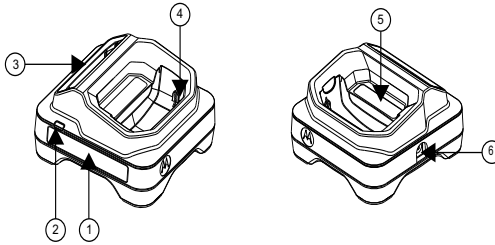
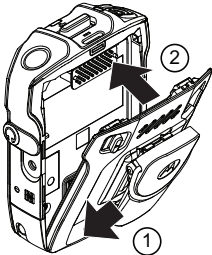

Table 3: Charger Overview and Description

No.	Description
1	Charging Indicators Label
2	Charger Indicator for Battery
3	Battery charging pocket
4	RSM charging pocket
5	Battery Caution Label
6	Power supply input

Attaching the Battery



1. Slot in the bottom side of the battery to the RSM battery contact.
2. Press firmly in the middle to ensure both latches snap in place and fully locked.

Detaching Battery

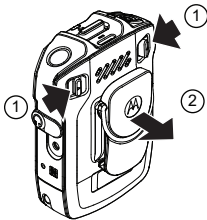

1. Pinch the left and right latches simultaneously.
2. Pull out the clip to remove the battery.

Getting Started

Before you start, fully charge the WM800 RSM.

Charging WM800 RSM and Battery

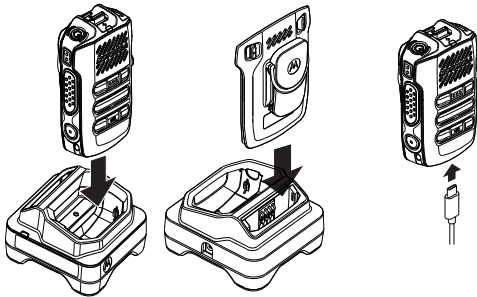

Table 4: Charging Indication

Power Indicator	Description
Solid red	Charging.
Blinking green	Charged up to 90% or more.
Solid green	Close to fully charged or fully charged.
Blinking amber	Battery is waiting to charge. (Either the battery voltage is too low or the battery temperature is too low or too high to allow charging. When this condition is corrected, the battery will automatically begin charging.)
Rapid blinking red	Charging error.

Table 5: Power Indication

Power Indicator	Description
Blinking green for one second	Power On
Blinking green twice	Power Off
Blinking red twice	Power up error

Table 6: Battery Indication

Power Indicator	Description
Off	Battery is medium or high level. NOTE: Refer to Check Battery and Connection Status feature in Table 5 for more information about the battery status.
Blinking red	Battery at low level. NOTE: Voice and Tone Prompt are announced every two minutes until the device starts charging.
Rapid blinking red	Battery at critical level. Charge the RSM immediately to prevent flat-battery. NOTE: Voice and Tone prompt are announced every 30 seconds until the device starts charging.

Table 7: Audio/Bluetooth Status

Audio/Bluetooth Indicator	Description
Blinking blue	Pairing mode

Table 7: Audio/Bluetooth Status

Audio/Bluetooth Indicator	Description
Solid blue	• Connecting • Reconnecting • Disconnected
Off	Connected NOTE: Refer to Check Battery and Connection Status feature in Table 3 for more information about the connection status.

NOTE: Refer to the LED indicators on the device for the WM800 RSM charging status. Refer to the LED indicator on the charger for battery only charging status.

Replacement Parts and Accessories

Table 8: Replacement Parts and Accessories

Part Number	Description
PMMN4156_	Wireless RSM (without Battery)
PMNN4846_	Wireless RSM Battery (included Swivel Clip)
PMPN4653_	DUC with Power Supply United States Plug
PMPN4654_	DUC with Power Supply Australia/New Zealand Plug
PMPN4749_	DUC with Power Supply EU Plug
PMPN4751_	DUC with Power Supply Argentina Plug
PMPN4752_	DUC with Power Supply UK / Hong Kong Plug

Table 8: Replacement Parts and Accessories

Part Number	Description
PMPN4750_	DUC with Power Supply Brazil Plug
PMKN4294_	USB-C Cable (1 m)
PMLN8312_	Low Profile Swivel Clip with D-Ring
PMLN8650_	N-Ear 360 Flexo™ Dynamic Braided Fiber Cloth™ Single Ear Earpiece
PMLN8652_	Receive-Only Extra Loud Earpiece with Translucent Tube, 3.5 mm Jack
PMLN8682_	Coiled lanyard (pack of five)
PMLN8675_	Swivel MOLLE Clip

Holding Your RSM While Transmitting Audio

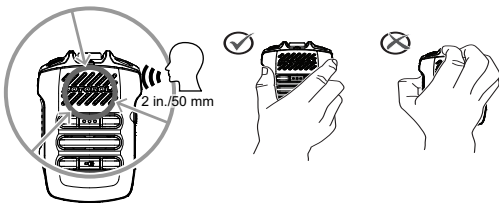

1. Hold your Remote Speaker Microphone (RSM) 1 in. to 2 in. from your mouth without blocking the top half of the RSM especially in a noisy environment.

a “Pairing Cleared” voice prompt from the WM800 RSM indicates that the paired device is deleted from the paired device list.

NOTES:

- Depending on the radio codeplug configuration and ways to pair the devices, the WM800 RSM paired device list is cleared when the WM800 RSM is turned off.
- Refer to the radio user manual for more details on the pairing programmable options.
- Always unpair the WM800 from the Bluetooth host and ensure that the paired device is removed from the paired device list before starting another pairing process.

Attaching Secondary Audio Accessory

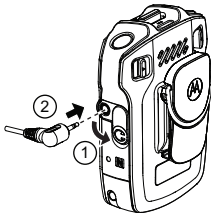

Cleaning Guidelines

The following procedures describe the recommended cleaning agents and the methods to be used when cleaning the external surfaces of your Remote Speaker Microphone (RSM). External surfaces include the housing assembly and battery case. These

surfaces must be cleaned whenever a periodic visual inspection reveals the presence of smudges, grease, and/or grime.

CAUTION: The only recommended agent for cleaning is a 0.5% solution of a mild dishwashing detergent in water. Other cleaning solutions may permanently damage the RSM housing and voids the warranty. Do not soak the RSM in the detergent water.

1. Mix one teaspoon of mild dishwashing detergent to one gallon of water (0.5% solution) to clean the external surfaces of the RSM with soft lint-free cloth.
2. Fully rinse the RSM with fresh water and dry thoroughly with soft lint-free cloth. If the RSM battery contact area has been exposed to water, dry and clean the battery contacts before attaching a battery to the RSM. Do not over-press the battery contact.
3. Hold the RSM with the front surface down, and lightly shake it a few times, to clear out water that maybe underneath the speaker grill openings or microphone ports.

Warranty

Motorola Solutions offers warranty for your RSM. Refer to your Motorola Solutions dealer or point-of-purchase for detailed information.

NOTE: Warranty is void after customer replacement of any parts other than replacement parts listed.

Warranty Exclusion

Motorola Solutions does not warrant the installation, maintenance or service of the Product, accessories, batteries, or parts. Motorola Solutions will not be responsible in any way for problems or damage caused by any ancillary equipment or peripherals (specific examples include, but are not limited to: batteries,

tery status and “Searching for Host” voice prompt, and the blue LED blinks during pairing mode.

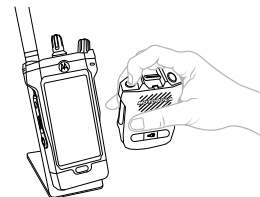

2. Open the NFC widget and follow the instruction on the radio to complete the pairing process.
3. Align the NFC tag from the WM800 RSM and the M logo at the back of the radio together until you hear the beep tone (successful detection).

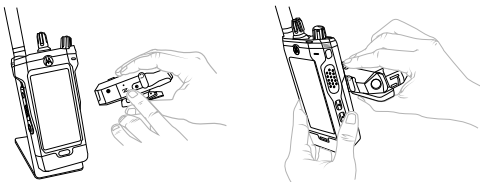

4. Observe the following in the radio and WM800 for a successful pairing:
 - The WM800 has short beeps until devices are successfully paired.
 - You hear the “Connected” voice prompt (if Language is selected).

- The Audio or Bluetooth LED blinks blue after a successful connection.
- If pairing is unsuccessful, the WM800 returns to pairing mode.

NOTE: The WM800 RSM pairing mode times out in two minutes.

Pairing Your WM800 RSM Through Motorola Proximity Pairing

1. While WM800 RSM is power off, press and hold the **Power** button until you hear “Power On” followed by battery status and “Searching for Host” voice prompt, and the blue LED blinks during pairing mode.
2. Align the Blue Dot on the WM800 RSM and the Blue Dot on the radio close together until you hear a beep tone indicating successful detection. Hold the devices together to complete the pairing process. Observe the following from the radio and the WM800 RSM for a successful pairing:
 - The WM800 has short beeps until the devices are successfully paired.
 - You hear the “Connected” voice prompt (if Language is selected).
- The Audio or Bluetooth LED blinks blue after a successful connection.
- If pairing is unsuccessful, the WM800 returns to pairing mode.

NOTE: The WM800 RSM pairing mode times out in two minutes.

Unpairing Your WM800 RSM

1. While WM800 RSM is power off, press and hold the Power button and PTT button. The blue LED blinks and